

39 972 000 **NOVA COSMOPOLITAN LIGHT FLUSH PLATE**

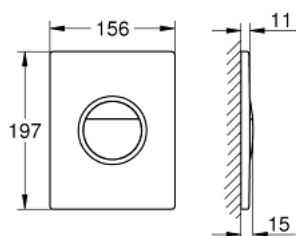

PRODUKTO APRAŠYMAS

- Spalva: chrome
 - for dual flush or start & stop actuation
 - external highlighted outline
 - with LEDs in blue, red, yellow, green
 - light colour individually adjustable
 - on/off button
 - timer for individual regulation of illuminating period
 - 3 m connecting cable
 - transformer for external installation
 - operating voltage 230 V AC
 - 50/60 Hz, 2.0 VA
 - CE approved
 - for pneumatic discharge valve AV1
 - vertical and horizontal installation
 - 156 x 197 mm
 - material: ABS
 - GROHE Long-Life finish
 - GROHE Water Saving - Less water, perfect flow
-
- for combination with Rapid SL and Uniset with GD 2 cistern
-
- for use with Rapid SLX please order shaft 66 791 000 (sold separately)



39 972 000 **NOVA COSMOPOLITAN LIGHT FLUSH PLATE**

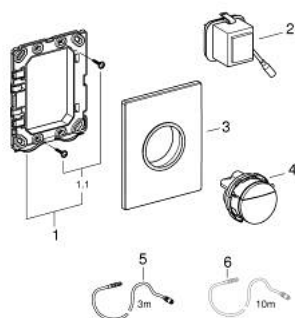

ATSARGINĖS DALYS , spalio 2021 – dabar

1: Mounting frame (Produkto nr. 42358000)

1.1: Screw (Produkto nr. 6636200M)

2: Switching power supply (Produkto nr. 66960000)

3: Top plate with electronic (Produkto nr. 42359000)

4: Push button (Produkto nr. 48614000)

5: Extension cable (Produkto nr. 36221000)

6: Extension cable (Produkto nr. 36222000)*

* pasirenkami priedai