

39 062 001 RAPID SL ELEMENT FOR WC WITH LEAKAGE BOX, 1.13 M INSTALLATION HEIGHT

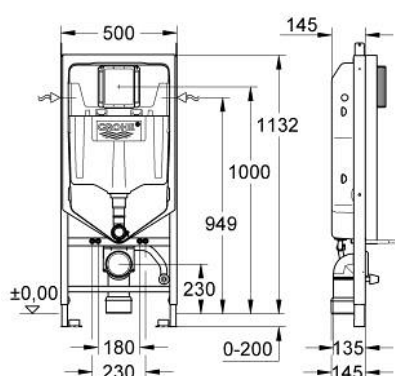

PRODUKTO APRAŠYMAS (1/2)

- with flushing cistern GD 2, 6 - 9 l
- for on-the-wall installations or studded walls
- with sealing fleece
- powder coated steel frame, self-supporting
- for dry-cladding, completely pre-assembled
- with fixed connections
- quick adjustment, lockable
- fixing material
- 2 WC fixing bolts
- fixing device for ceramic
- distance of fixing bolts 180/230 mm
- outlet bend Ø 90 mm
- depth adjustable
- reducer Ø 90/110 mm
- inlet and outlet connecting set
- leakage box
- collection body with wastewater lead-through and connection for spill, black
- leakage / splash water protection
- flushing cistern GD 2, 6 - 9 l, containing following features:
 - adjustment ex factory 6 l and 3 l
 - pneumatic discharge valve offering 3 modes of operation: dual flush or start/stop or single flush
- water supply from left/right or back
- low noise (group I acc. to German Noise Specification)
- fully insulated against condensation
- angle valve ½"
- water inlet with pipe fixation
- no tools required for the installation of the inspection shaft incl. protection during construction phase
- for vertical or horizontal use
- including wall brackets 38 558 00M for on-the-wall installation

Pure Freude
an Wasser



39 062 001 **RAPID SL ELEMENT FOR WC WITH LEAKAGE BOX, 1.13 M INSTALLATION HEIGHT**

PRODUKTO APRAŠYMAS (2/2)

- for mounting of small flush plates please order revision shaft 40 911 000 (sold separately)
- including adapter 38 338 000
- including seal for leakage box