

36 411 000 EUROPLUS E BLUETOOTH INFRA-RED ELECTRONIC BASIN TAP 1/2" WITH MIXING DEVICE

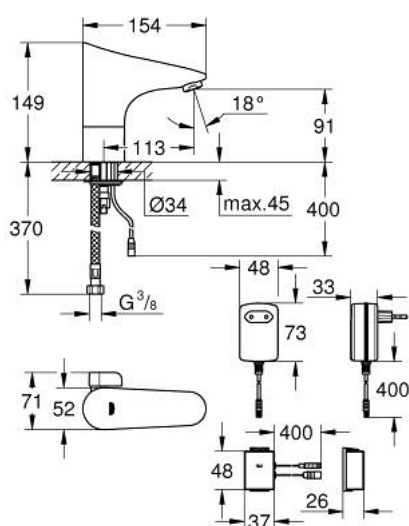

PRODUKTO APRAŠYMAS (1/2)

- Spalva: chrome
- with infrared sensor and Bluetooth module for bi-directional communication for monitoring, configuration and service purpose
- with plug transformer 100-240 V AC, 50-60 Hz, 6.75 V DC
- rapid installation system
- mixing device with adjustable hot water limiter
- GROHE Long-Life finish
- GROHE Water Saving mousseur 5.7 l/min
- with integrated solenoid valve
- integrated non-return valves and dirt strainers
- with Bluetooth® 4.0* for wireless data communication
- for Apple** and Android devices
- Bluetooth range (max. 10 m) varies depending on used materials and walls between transmitter and receiver
- monitoring
- password protected products
- app detects all Bluetooth products in range
- auto flush cycles and timing last auto flush
- usage per day / 30 days
- thermal disinfection cycles and timings last disinfection
- configuration
- detection range and shut off delay
- auto flush
- thermal disinfection
- cleaning mode
- 2 on/off timers
- service
- send and save 3 profiles
- reset to factory or user settings
- hard and software version
- CE approved
- acoustic group I in accordance with DIN 4109
- type of protection faucet IP 59K

36 411 000 EUROPLUS E BLUETOOTH INFRA-RED ELECTRONIC BASIN TAP 1/2" WITH MIXING DEVICE

PRODUKTO APRAŠYMAS (2/2)

- Mobile devices and GROHE IR Remote App*** are not included in delivery and have to be ordered separately via an authorised Apple store/store/iTunes or Google Play store.
- * The Bluetooth® word mark and logos are registered trademarks owned by Bluetooth SIG, Inc. and any use of such marks by Grohe AG is under license. Other trademarks and trade names are those of their respective owners.
- ** Apple, the Apple logo, iPod, iPod Touch, iPhone and iTunes are trademarks of Apple Inc., registered in the U.S. and other countries. Apple is not responsible for the function of this device or its compliance with safety and regulatory standards.
- *** Available for free via iTunes app or Google Play store.

36 411 000 EUROPLUS E BLUETOOTH INFRA-RED ELECTRONIC BASIN TAP 1/2" WITH MIXING DEVICE

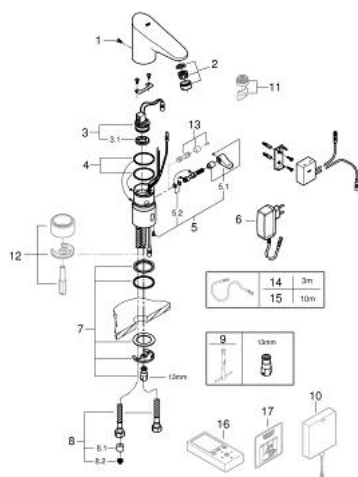

ATSARGINĖS DALYS , rugsėjo 2014 – dabar

- 1: Screws (Produkto nr. 4283100M)
- 2: Mousseur (Produkto nr. 48159000)
- 3: Solenoid valve (Produkto nr. 42229000)
- 3.1: Dirt strainer (Produkto nr. 42798000)
- 4: Sealing washer (Produkto nr. 4283600M)
- 5: Mixer spindle with lever (Produkto nr. 42839000)
- 5.1: Mixing lever (Produkto nr. 42838000)
- 5.2: Sealing washer (Produkto nr. 4284000M)
- 6: Mains adaptor (Produkto nr. 42388000)
- 7: Fixing set (Produkto nr. 42841000)
- 8: Connection hose (Produkto nr. 42403000)
- 8.1: Non-return valve (Produkto nr. 4240400M)
- 8.2: Filter (Produkto nr. 4241300M)
- 9: Mounting wrench (Produkto nr. 19017000)*
- 10: Switch-mode power supply (Produkto nr. 36338000)*
- 11: Mousseur (Produkto nr. 36133000)*
- 12: Socket (Produkto nr. 36210000)*
- 13: Hidden mixing device (Produkto nr. 36209000)*
- 14: Power extension cable (Produkto nr. 36340000)*
- 15: Power extension cable (Produkto nr. 36341000)*
- 16: Remote control (Produkto nr. 36407001)*
- 17: Sticker with pictograph (Produkto nr. 4217700M)*

* pasirenkami priedai