

36 384 000 EUROECO COSMOPOLITAN E POWERBOX

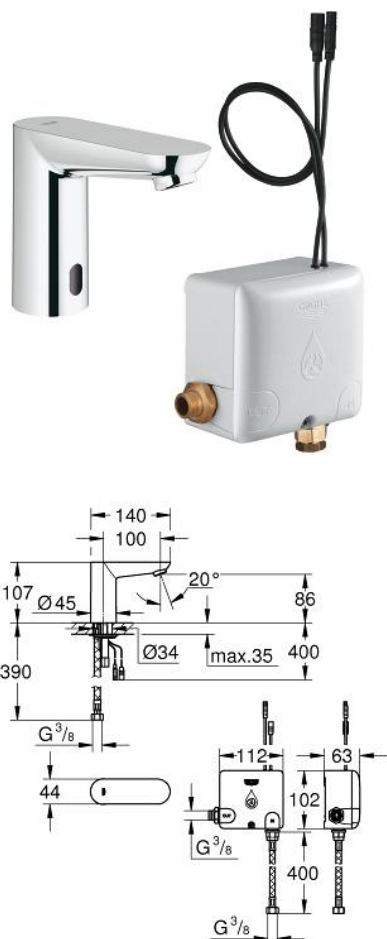

PRODUKTO APRAŠYMAS

- Spalva: chrome
- infra-red electronic basin tap 1/2" without mixer
- with infrared sensor for bi-directional communication for monitoring, configuration and service purpose
- including Powerbox self-generating power system
- GROHE Long-Life finish
- GROHE Water Saving - Less water, perfect flow
- maximum flow rate (at 3 bar): 5 l/min
- flexible connection hose
- dirt strainer
- rapid installation system
- Powerbox
- power generator with water turbine
- internal energy saving unit
- with use of 60 s/24 h stand-by, 260 s/100 h stand-by
- with additional backup power
- 7 pre-set programs:
- auto flush
- thermal disinfection
- cleaning mode
- additional functions and precise settings by remote control 36 407

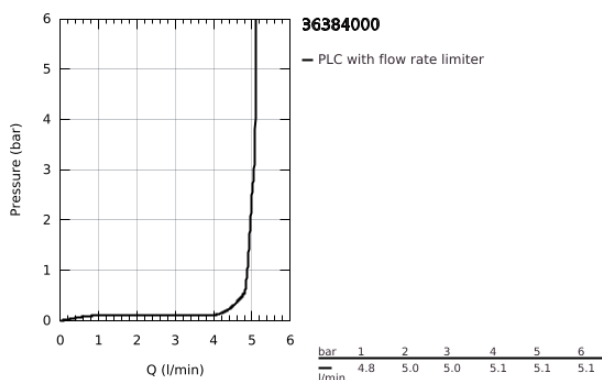

36 384 000 EUROECO COSMOPOLITAN E POWERBOX

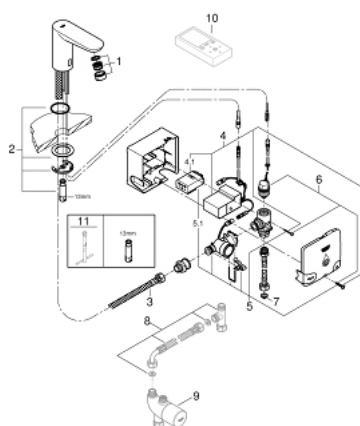

ATSARGINĖS DALYS , rugpjūčio 2016 – dabar

- 1: Mousseur (Produkto nr. 48159000)
- 2: Shank mounting kit (Produkto nr. 42389000)
- 3: Connection hose (Produkto nr. 46255000)
- 4: Electronic (Produkto nr. 42458000)
- 4.1: Battery housing (Produkto nr. 42393000)
- 5: Generator (Produkto nr. 42457000)
- 5.1: Battery housing (Produkto nr. 42393000)
- 6: Solenoid valve (Produkto nr. 42456000)
- 7: Filter (Produkto nr. 4241300M)
- 8: Connection set (Produkto nr. 47533000)*
- 9: Thermostatic scalding protection (Produkto nr. 34487000)*
- 10: Remote control (Produkto nr. 36407001)*
- 11: Mounting wrench (Produkto nr. 19017000)*

* pasirenkami priedai