

32 168 DC0 MINTA SINGLE-LEVER SINK MIXER 1/2"

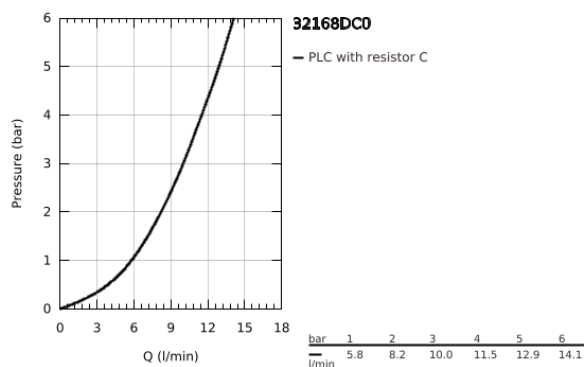

PRODUKTO APRAŠYMAS

- Spalva: supersteel
- L-spout
- single hole installation
- GROHE Long-Life finish
- GROHE SilkMove 46 mm ceramic cartridge
- pull-out mousseur
- adjustable flow rate limiter
- swivel tubular spout
- swivel area 360°
- integrated non-return valves
- protected against backflow
- flexible connection hoses
- rapid installation system
- maximum flow rate (at 3 bar): 10 l/min

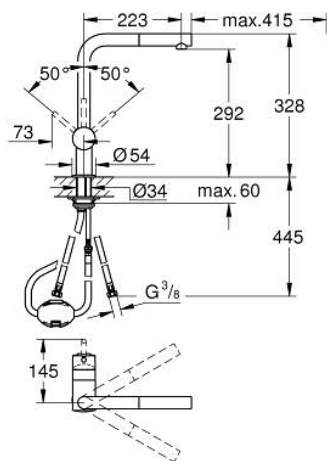

32 168 DC0 MINTA SINGLE-LEVER SINK MIXER 1/2"

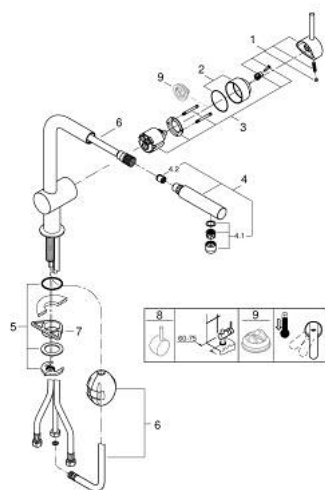

ATSARGINĖS DALYS , balandžio 2024 – dabar

- 1: Lever (Produkto nr. 46015DC0)
 - 2: Cap (Produkto nr. 46025DC0)
 - 3: Cartridge (Produkto nr. 46048000)
 - 4: Pull out spray (Produkto nr. 46858DC0)
 - 4.1: Non-return valve (Produkto nr. 08565000)
 - 4.2: Mousseur (Produkto nr. 13967DC0)
 - 5: Shank mounting kit (Produkto nr. 46345000)
 - 6: Hose for sink mixer with pull-out dual spray or mousseur (Produkto nr. 48293000)
 - 7: Support plate (Produkto nr. 05334000)
 - 8: Temperature limiter (Produkto nr. 46375000)*
- * pasirenkami priedai