

## 31 593 DC2 ZEDRA SMARTCONTROL SINK MIXER WITH SMARTCONTROL

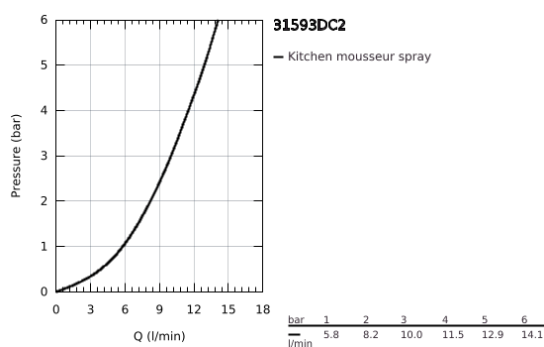

### PRODUKTO APRAŠYMAS

- Spalva: supersteel
- single hole installation
- GROHE Long-Life finish
- pull-out spray with laminar
- metal spray
- GROHE Magnetic Docking guarantees easy retraction and smooth docking of the spray head back to the starting position
- GROHE SmartControl push for ON-OFF, turn for volume adjustment from water saving eco mode to Full Flow
- temperature adjustment by turning of mixing valve on body
- swivel tubular spout
- swivel area 140°
- protected against backflow
- flexible connection hoses
- metal fixation set
- Lead and Nickel Free Inner Water Ways
- maximum flow rate (at 3 bar): 10 l/min

## 31 593 DC2 ZEDRA SMARTCONTROL SINK MIXER WITH SMARTCONTROL

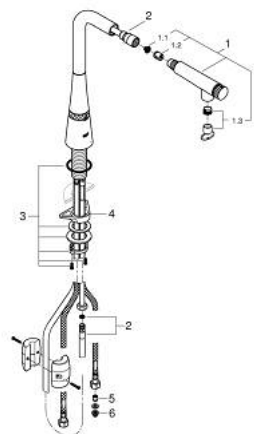

**ATSARGINĖS DALYS** , liepos 2018 – dabar

1: Pull out spray (Produkto nr. 48487DC0)

1.1: Dirt strainer (Produkto nr. 0676800M)

1.2: Non-return valve (Produkto nr. 08565000)

1.3: Flow control set (Produkto nr. 48470000)

2: Shower hose (Produkto nr. 48488000)

3: Shank fastening assembly (Produkto nr. 48384000)

4: Support plate (Produkto nr. 05334000)

5: Non-return valve (Produkto nr. 45881000)

6: Dirt strainer (Produkto nr. 0676800M)