

31 358 DC2 MINTA TOUCH ELECTRONIC SINGLE-LEVER SINK MIXER 1/2"

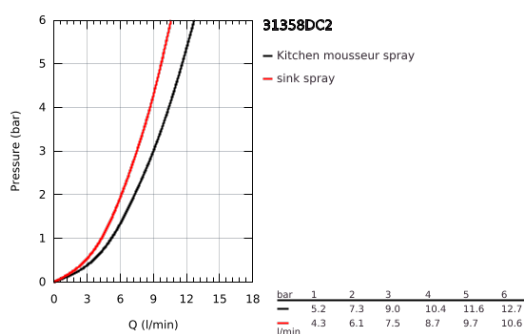

PRODUKTO APRAŠYMAS

- Spalva: supersteel
- C-spout
- single hole installation
- Touch: activation of water via skin contact
- battery supply 6 V lithium-battery, type CR-P2
- CE approved
- solenoid valve
- fixed value mixing valve
- automatic safety stop after 60 sec. (factory set)
- type of protection IP 44
- GROHE Long-Life finish
- GROHE SilkMove 46 mm ceramic cartridge
- pull-out dual spray
- diverter: laminar spray/SpeedClean shower jet
- swivel tubular spout
- swivel area 360°
- protected against backflow
- flexible connection hoses
- rapid installation system
- maximum flow rate (at 3 bar): 9 l/min

31 358 DC2 MINTA TOUCH ELECTRONIC SINGLE-LEVER SINK MIXER 1/2"

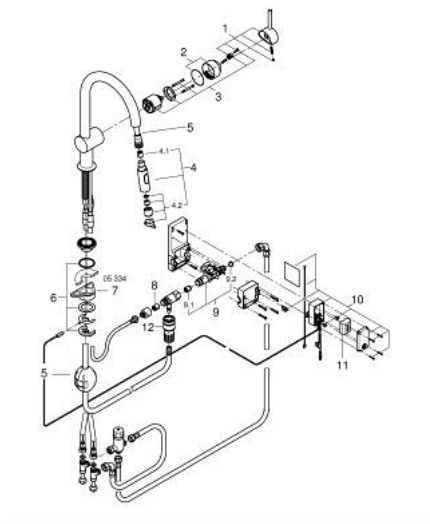

ATSARGINĖS DALYS , birželio 2024 – dabar

- 1: Lever (Produkto nr. 46015DC0)
- 2: Cap (Produkto nr. 46025DC0)
- 3: Cartridge (Produkto nr. 46048000)
- 4: Pull out spray (Produkto nr. 48416DC0)
- 4.1: Non-return valve (Produkto nr. 08565000)
- 4.2: Flow straightener (Produkto nr. 48347000)
- 5: Hose for sink mixer with pull-out dual spray or mousseur (Produkto nr. 48293000)
- 6: Shank mounting kit (Produkto nr. 46345000)
- 7: Support plate (Produkto nr. 05334000)
- 8: Non-return valve (Produkto nr. 08565000)
- 9: Solenoid valve (Produkto nr. 48213000)
- 9.1: Non-return valve (Produkto nr. 08565000)
- 9.2: Dirt strainer (Produkto nr. 42395000)
- 10: Control unit (Produkto nr. 48214000)
- 11: Battery (Produkto nr. 42886000)
- 12: Quick coupling (Produkto nr. 46338000)