

30 505 DC0 ESSENCE SINGLE-LEVER SINK MIXER 1/2"

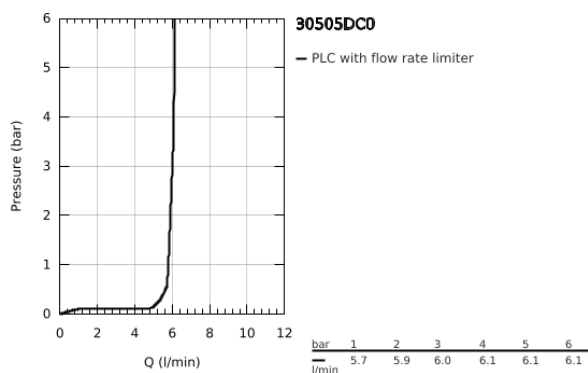

PRODUKTO APRAŠYMAS

- Spalva: supersteel
- single hole installation
- GROHE Long-Life finish
- GROHE SilkMove 28 mm ceramic cartridge
- GROHE AquaGuide adjustable mousseur
- swivel tubular spout
- adjustable swivel area 0° / 150° / 360°
- flexible connection hoses
- rapid installation system
- integrated temperature limiter
- maximum flow rate (at 3 bar): 6.5 l/min
- professional edition

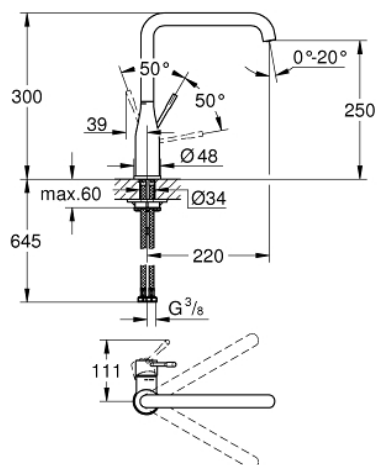

30 505 DC0 ESSENCE SINGLE-LEVER SINK MIXER 1/2"



ATSARGINĖS DALYS , vasario 2022 – dabar

- 1: Lever (Produkto nr. 46927DC0)
- 2: Cartridge (Produkto nr. 46580000)
- 3: screw ring (Produkto nr. 48591000)
- 4: L-spout (Produkto nr. 13376DC0)
- 4.1: Mousseur (Produkto nr. 48270000)
- 4.2: Sealing washer (Produkto nr. 0128500M)
- 4.3: Safety ring (Produkto nr. 4826600M)
- 5: Escutcheon (Produkto nr. 48603DC0)
- 6: Shank mounting kit (Produkto nr. 46671000)
- 7: Support plate (Produkto nr. 05334000)
- 8: Mounting wrench (Produkto nr. 19017000)*

* pasirenkami priedai