

30 262 001 **START SINGLE-LEVER SINK MIXER 1/2"**

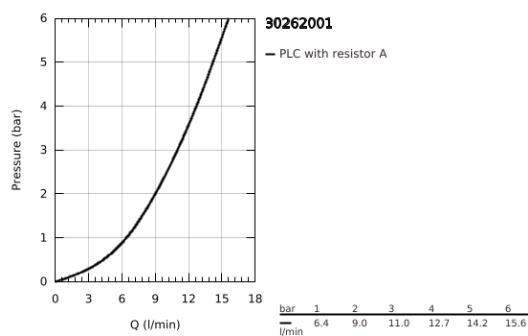

PRODUKTO APRAŠYMAS

- Spalva: chrome
- integrated stop valve
- GROHE SilkMove Energy Saving 35 mm ceramic cartridge with energy saving function via cold start
- GROHE Long-Life finish
- adjustable flow rate limiter
- swivel tubular spout
- swivel area 90°
- mousseur
- flexible connection hoses
- rapid installation system
- GROHE FastFixation installation system

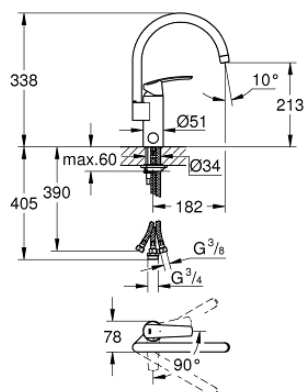

30 262 001 **START SINGLE-LEVER SINK MIXER 1/2"**

