

29 149 000 **SMARTCONTROL CONCEALED MIXER WITH 3 VALVES**

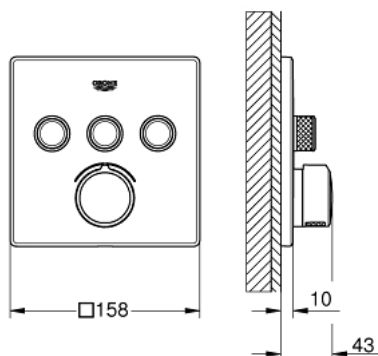

PRODUKTO APRAŠYMAS

- Spalva: chrome
- set for final installation for
- GROHE Rapido SmartBox 35 600/35 604
- metal wall escutcheon with GROHE FastFixation (covered escutcheon and shaft sealing, covered fixing), retroactively 6° adjustable
- GROHE Long-Life finish
- GROHE SmartControl push for ON-OFF, turn for volume adjustment from GROHE Water Saving to full flow
- exchangeable symbols
- cartridge for temperature mixing
- multiple outlets can be run simultaneously
- without roughing-in-set
- flow performance: outlet A = 22 l/min outlet B = 26 l/min outlet C = 22 l/min outlet A + B = 31 l/min outlet A + B + C = 34 l/min



29 149 000 **SMARTCONTROL CONCEALED MIXER WITH 3 VALVES**

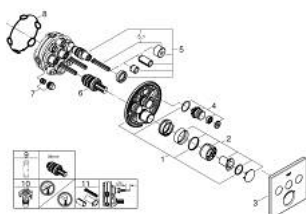

ATSARGINĖS DALYS , rugsėjo 2020 – dabar

- 1: Mounting plate (Produkto nr. 48362000)
- 2: Handle (Produkto nr. 46990000)
- 3: Escutcheon (Produkto nr. 46996000)
- 4: Push button (Produkto nr. 48361000)
- 5: Cartridge (Produkto nr. 48359000)
- 5.1: Spindle (Produkto nr. 49088000)
- 6: Cartridge (Produkto nr. 46989000)
- 7: Non-return valves (Produkto nr. 47979000)
- 8: Seal (Produkto nr. 48360000)
- 9: Socket spanner (Produkto nr. 49059000)*
- 10: Service stops (Produkto nr. 1405300M)*
- 11: Universal extension set single-lever mixers, 25 mm (Produkto nr. 14048000)*

* pasirenkami priedai