

29 125 000 GROHTHERM SMARTCONTROL THERMOSTAT FOR CONCEALED INSTALLATION WITH 2 VALVES AND INTEGRATED SHOWER HOLDER

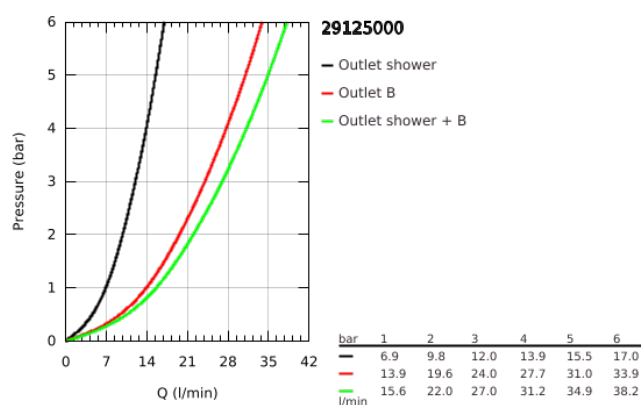

PRODUKTO APRAŠYMAS

- Spalva: chrome
- set for final installation for
- GROHE Rapido SmartBox 35 600/35 604
- metal wall escutcheon with GROHE FastFixation (covered escutcheon and shaft sealing, covered fixing), retroactively 6° adjustable
- GROHE Long-Life finish
- GROHE SmartControl push for ON-OFF, turn for volume adjustment from GROHE Water Saving to Full Flow
- exchangeable symbols
- GROHE TurboStat compact cartridge with wax thermoelement
- GROHE ProGrip with knurl structure
- GROHE SafeStop at 38°C
- GROHE SafeStop Plus optional temperature limiter at 43°C or 46°C included
- built-in non return valves and dirt strainers
- multiple outlets can be run simultaneously
- integrated shower union with shower outlet 1/2"
- without roughing-in-set
- flow performance: outlet B = 24 l/min hand shower = 12 l/min outlet B + hand shower = 27 l/min



29 125 000 GROHTHERM SMARTCONTROL THERMOSTAT FOR CONCEALED INSTALLATION WITH 2 VALVES AND INTEGRATED SHOWER HOLDER

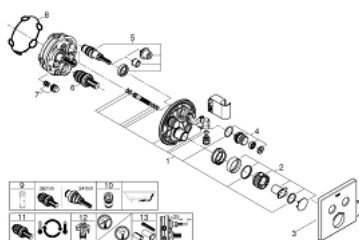

ATSARGINĖS DALYS , rugsėjo 2016 – dabar

- 1: Mounting template (Produkto nr. 48364000)
- 2: Temperature control handle (Produkto nr. 49029000)
- 2.1: Cover cap (Produkto nr. 1015030000)
- 2.2: handle adaptor (Produkto nr. 1015059990)
- 3: Escutcheon (Produkto nr. 49041000)
- 4: Push button (Produkto nr. 48361000)
- 4.1: pushbutton (Produkto nr. 14077000)
- 5: Cartridge (Produkto nr. 48359000)
- 5.1: Spindle (Produkto nr. 49088000)
- 6: Thermostatic compact cartridge 3/4" (Produkto nr. 49028000)
- 7: Non-return valves (Produkto nr. 47979000)
- 8: Seal (Produkto nr. 48360000)
- 9: Socket spanner (Produkto nr. 49059000)*
- 10: Backflow protection combination (DIN-EN1717) (Produkto nr. 14055000)*
- 11: GROHE TurboStat cartridge 3/4" (Produkto nr. 49003000)*
- 12: Service stops (Produkto nr. 1405300M)*
- 13: Universal extension set single-lever mixers, 25 mm (Produkto nr. 14048000)

)*

* pasirenkami priedai