

27 296 003 EUPHORIA SYSTEM 260 SHOWER SYSTEM WITH THERMOSTATIC MIXER FOR WALL MOUNTING

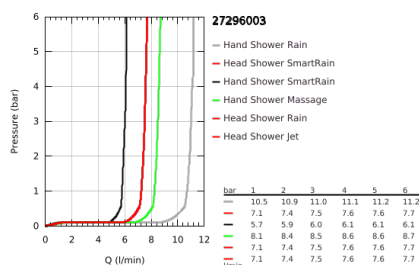
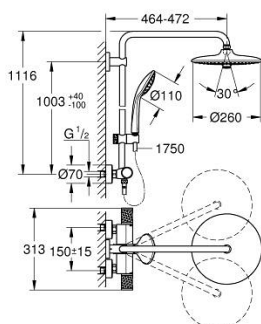

PRODUKTO APRAŠYMAS (1/2)

- Spalva: chrome
- consisting of:
 - horizontal swivable 450 mm shower arm
 - exposed thermostat with Aquadimmer function
 - allows change between:
 - head shower Euphoria 260 (26 455)
 - 3 spray patterns:
 - Rain, SmartRain, Jet
 - maximum flow rate (at 3 bar): 7.5 l/min
 - with ball joint
 - rotation angle $\pm 15^\circ$
 - hand shower Euphoria 110 Massage (27 221 000)
 - 3 spray patterns:
 - Rain, Massage, SmartRain
 - maximum flow rate (at 3 bar): 11 l/min
 - adjustable in height with gliding element
 - Silverflex shower hose 1750 mm 1/2" x 1/2" (28 388)
 - GROHE TurboStat compact cartridge with wax thermoelement
 - GROHE SafeStop at 38°C
 - GROHE SafeStop Plus optional temperature limiter at 43°C included
 - GROHE CoolTouch no risk of scalding
 - GROHE ProGrip with knurl structure
 - GROHE DreamSpray perfect spray pattern
 - GROHE Long-Life finish
 - GROHE SprayDimmer (Stepless flow rate reduction)
 - GROHE FastFixation upper bracket adjustable
 - Inner WaterGuide for a longer life
 - SpeedClean anti-lime system
 - TwistStop to prevent hose from twisting
 - suitable for instantaneous heaters from 18 kW/h
 - minimum flow rate 7 l/min.
 - optional upgrade: GROHE EasyReach tray (26 362)
 - professional edition

Pure Freude
an Wasser



27 296 003 EUPHORIA SYSTEM 260 SHOWER SYSTEM WITH THERMOSTATIC MIXER FOR WALL MOUNTING

PRODUKTO APRAŠYMAS (2/2)

- minimum flow rate 5 l/min.

27 296 003 EUPHORIA SYSTEM 260 SHOWER SYSTEM WITH THERMOSTATIC MIXER FOR WALL MOUNTING



ATSARGINĖS DALYS , sausio 2020 – dabar

- 1: Shut-off handle (Produkto nr. 49162000)
- 2: Stop ring (Produkto nr. 47986000)
- 3: Stop ring (Produkto nr. 47965000)
- 4: Aquadimmer (Produkto nr. 47364000)
- 5: Water flow (Produkto nr. 47887000)
- 6: Shut-off handle (Produkto nr. 49160000)
- 7: Fitting ring (Produkto nr. 47743000)
- 8: Thermostatic compact cartridge 1/2" (Produkto nr. 47439000)
- 9: Race (Produkto nr. 47975000)
- 10: Non-return valve (Produkto nr. 47189000)
- 10.1: Dirt strainer (Produkto nr. 0726400M)
- 10.2: Non-return valve (Produkto nr. 08565000)
- 10.3: O-ring $\varnothing 17 \times \varnothing 2$ (Produkto nr. 0305500M)
- 11: S-union (Produkto nr. 12662000)
- 12: Glide element (Produkto nr. 48424000)
- 13: Dirt strainer (Produkto nr. 0700200M)
- 14: Fibre seal $\varnothing 18,5 \times \varnothing 12 \times 2$ (Produkto nr. 0138900M)
- 15: Dirt strainer (Produkto nr. 48007000)
- 16: Shower bar holder (Produkto nr. 48279000)
- 17: Shower system pipe for retrofitting (Produkto nr. 48514000)*
- 18: Shower system pipe for retrofitting (Produkto nr. 48515000)*
- 19: Special spanner (Produkto nr. 19377000)*
- 20: Socket spanner (Produkto nr. 19332000)*
- 21: GROHE TurboStat cartridge 1/2" (Produkto nr. 47175000)*
- 22: Compensation disc (Produkto nr. 27180000)*
- 23: Shower arm for shower systems (Produkto nr. 14047000)*
- 24: GROHE EasyReach tray (Produkto nr. 26362LN1)*

* pasirenkami priedai