

26 243 000 EUPHORIA SYSTEM SHOWER SYSTEM WITH BATH THERMOSTAT FOR WALL MOUNTING

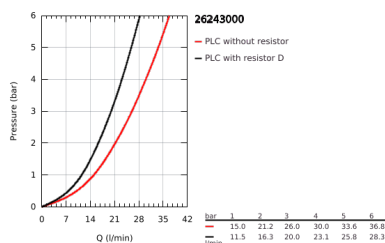

PRODUKTO APRAŠYMAS

- Spalva: chrome
- with short shower rail for installation in showers
- consisting of:
 - horizontal swivable 450 mm shower arm
 - exposed thermostat with Aquadimmer function
 - separate diverter for hand shower
 - gliding element
- Silverflex shower hose 1750 mm 1/2" x 1/2" (28 388)
- distance between thermostat and upper bracket: 1016 mm
- GROHE TurboStat compact cartridge with wax thermoelement
- GROHE SafeStop at 38°C
- GROHE SafeStop Plus optional temperature limiter at 43°C included
- GROHE Long-Life finish
- Inner WaterGuide for a longer life
- TwistStop to prevent hose from twisting
- suitable for instantaneous heaters from 18 kW/h
- minimum flow rate 7 l/min.

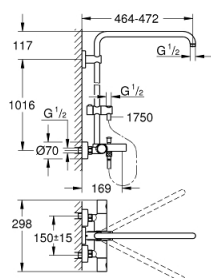

26 243 000 EUPHORIA SYSTEM SHOWER SYSTEM WITH BATH THERMOSTAT FOR WALL MOUNTING

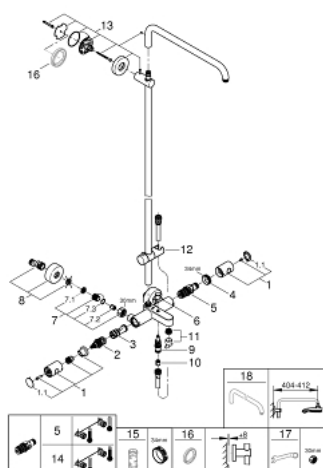

ATSARGINĖS DALYS , liepos 2017 – kovo 2021

- 1: Metal handle 1/2" (Produkto nr. 47984000)
- 1.1: Cover cap (Produkto nr. 6458500M)
- 2: Aquadimmer (Produkto nr. 47364000)
- 3: Water flow (Produkto nr. 47887000)
- 4: Fitting ring (Produkto nr. 47743000)
- 5: Thermostatic compact cartridge 1/2" (Produkto nr. 47439000)
- 6: Diverter knob (Produkto nr. 65648000)
- 7: Non-return valve (Produkto nr. 47189000)
- 7.1: Dirt strainer (Produkto nr. 0726400M)
- 7.2: Non-return valve (Produkto nr. 08565000)
- 7.3: O-ring $\varnothing 17 \times \varnothing 2$ (Produkto nr. 0305500M)
- 8: S-union (Produkto nr. 12662000)
- 9: Diverter (Produkto nr. 65655000)
- 10: Non-return valve (Produkto nr. 08565000)
- 11: Mousseur (Produkto nr. 13926000)
- 12: Glide element (Produkto nr. 12140000)
- 13: Shower bar holder (Produkto nr. 48279000)
- 14: GROHE TurboStat cartridge 1/2" (Produkto nr. 47175000)*
- 15: Socket spanner (Produkto nr. 19332000)*
- 16: Compensation disc (Produkto nr. 27180000)*
- 17: Special spanner (Produkto nr. 19377000)*
- 18: Shower arm for shower systems (Produkto nr. 14047000)*

* pasirenkami priedai