

## 26 075 001 EUPHORIA SYSTEM 310 SHOWER SYSTEM WITH THERMOSTATIC MIXER FOR WALL MOUNTING

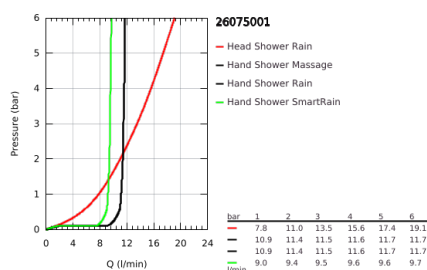

### PRODUKTO APRAŠYMAS

- Spalva: chrome
- consisting of:
  - horizontal swivable 450 mm shower arm
  - exposed thermostat with Aquadimmer function
  - allows change between:
    - head shower Rainshower Mono 310 (26 561)
    - spray pattern:
      - GROHE PureRain
      - maximum flow rate (at 3 bar): 13.5 l/min
    - with ball joint
    - rotation angle  $\pm 15^\circ$
    - hand shower Euphoria 110 Massage (27 221 000)
  - 3 spray patterns:
    - Rain, Massage, SmartRain
    - maximum flow rate (at 3 bar): 11.5 l/min
    - adjustable in height with gliding element
  - Silverflex shower hose 1750 mm 1/2" x 1/2" (28 388)
  - GROHE TurboStat compact cartridge with wax thermoelement
  - GROHE SafeStop at 38°C
  - GROHE SafeStop Plus optional temperature limiter at 43°C included
  - GROHE CoolTouch no risk of scalding
  - GROHE MetalGrip ergonomically shaped metal handles
  - GROHE DreamSpray perfect spray pattern
  - GROHE Long-Life finish
  - GROHE SprayDimmer (Stepless flow rate reduction)
  - GROHE FastFixation upper bracket adjustable
  - Inner WaterGuide for a longer life
  - SpeedClean anti-lime system
  - TwistStop to prevent hose from twisting
  - suitable for instantaneous heaters from 18 kW/h
  - minimum flow rate 7 l/min.
  - optional upgrade: GROHE EasyReach tray (26 362)
  - professional edition

## 26 075 001 EUPHORIA SYSTEM 310 SHOWER SYSTEM WITH THERMOSTATIC MIXER FOR WALL MOUNTING

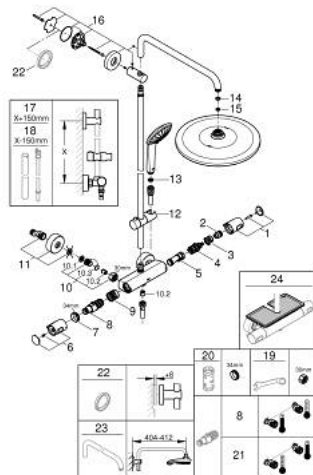

**ATSARGINĖS DALYS** , sausio 2020 – dabar

- 1: Shut-off handle (Produkto nr. 47991000)
- 2: Stop ring (Produkto nr. 47986000)
- 3: Stop ring (Produkto nr. 47965000)
- 4: Aquadimmer (Produkto nr. 47364000)
- 5: Water flow (Produkto nr. 47887000)
- 6: Handle (Produkto nr. 47992000)
- 7: Fitting ring (Produkto nr. 47743000)
- 8: Thermostatic compact cartridge 1/2" (Produkto nr. 47439000)
- 9: Race (Produkto nr. 47975000)
- 10: Non-return valve (Produkto nr. 47189000)
- 10.1: Dirt strainer (Produkto nr. 0726400M)
- 10.2: Non-return valve (Produkto nr. 08565000)
- 10.3: O-ring  $\varnothing 17 \times \varnothing 2$  (Produkto nr. 0305500M)
- 11: S-union (Produkto nr. 12662000)
- 12: Glide element (Produkto nr. 12140000)
- 13: Dirt strainer (Produkto nr. 0700200M)
- 14: Fibre seal  $\varnothing 18,5 \times \varnothing 12 \times 2$  (Produkto nr. 0138900M)
- 15: Dirt strainer (Produkto nr. 48007000)
- 16: Shower bar holder (Produkto nr. 48279000)
- 17: Shower system pipe for retrofitting (Produkto nr. 48514000)\*
- 18: Shower system pipe for retrofitting (Produkto nr. 48515000)\*
- 19: Special spanner (Produkto nr. 19377000)\*
- 20: Socket spanner (Produkto nr. 19332000)\*
- 21: GROHE TurboStat cartridge 1/2" (Produkto nr. 47175000)\*
- 22: Compensation disc (Produkto nr. 27180000)\*
- 23: Shower arm for shower systems (Produkto nr. 14047000)\*
- 24: GROHE EasyReach tray (Produkto nr. 26362LN1)\*

\* pasirenkami priedai