

## 23 315 000 GRANDERA SINGLE-LEVER BIDET MIXER 1/2" M-SIZE

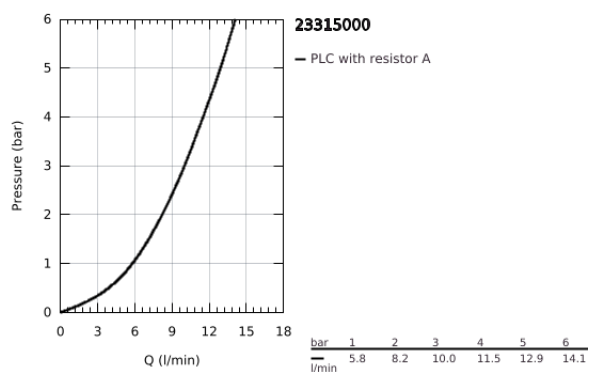

### PRODUKTO APRAŠYMAS

- Spalva: chrome
- single hole installation
- GROHE SilkMove 28 mm ceramic cartridge
- temperature limiter
- GROHE Long-Life finish
- GROHE FastFixation installation system
- ball-joint mousseur
- pop-up waste set 1 1/4"
- flexible connection hoses

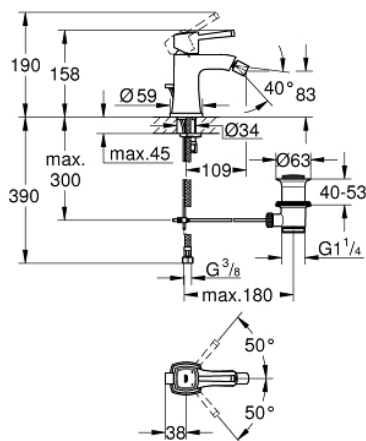

## 23 315 000 GRANDERA SINGLE-LEVER BIDET MIXER 1/2" M-SIZE

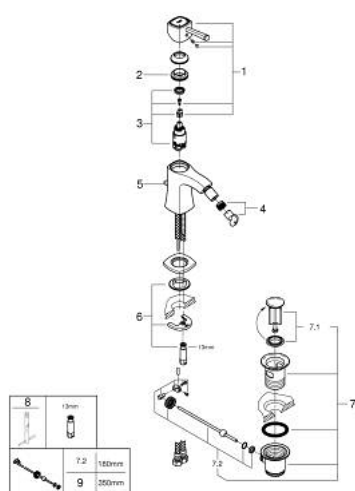

**ATSARGINĖS DALYS**, birželio 2012 – dabar

- 1: Lever (Produkto nr. 46836000)
  - 2: Fitting ring (Produkto nr. 46715000)
  - 3: Cartridge (Produkto nr. 46580000)
  - 4: Mousseur (Produkto nr. 13989000)
  - 5: Pop-up rod (Produkto nr. 46787000)
  - 6: Shank mounting kit (Produkto nr. 46671000)
  - 7: Waste set 1 1/4" (Produkto nr. 28910000)
  - 7.1: Plug (Produkto nr. 07182000)
  - 7.2: Eccentric rod (Produkto nr. 07052000)
  - 8: Mounting wrench (Produkto nr. 19017000)\*
  - 9: Eccentric rod (Produkto nr. 07341000)\*
- \* pasirenkami priedai