

## 20 421 000 BAUEDGE PILLAR TAP 1/2" XS-SIZE

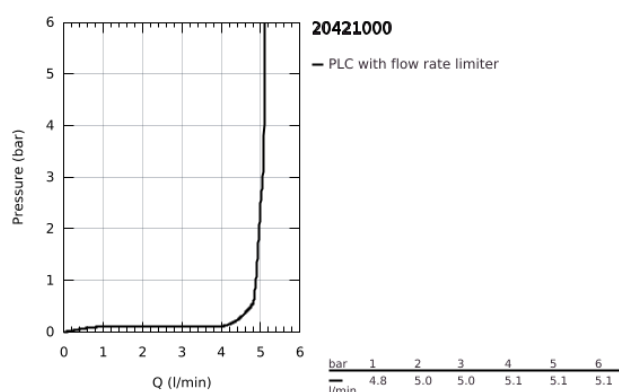

### PRODUKTO APRAŠYMAS

- Spalva: chrome
- single hole installation
- ceramic headpart 1/2", 90°
- GROHE Long-Life finish
- GROHE Water Saving - Less water, perfect flow
- maximum flow rate (at 3 bar): 5 l/min
- fixation nut G 1/2"

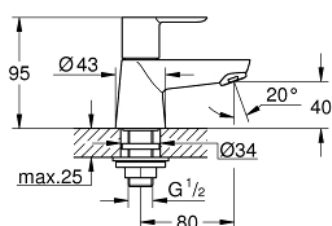

20 421 000 **BAUEDGE PILLAR TAP 1/2"**  
**XS-SIZE**

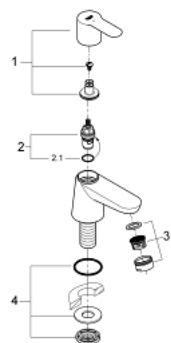

**ATSARGINĖS DALYS** , rugsėjo 2012 – dabar

1: Lever (Produkto nr. 48028000)

1.1: Replacement handle connection kit (Produkto nr. 45186000)

1.1.1: O-ring Ø 18.2 x Ø 1.7 (Produkto nr. 0392400M)

2: Ceramic headpart, 1/2" (Produkto nr. 45882000)

2.1: O-ring Ø 18.2 x Ø 1.7 (Produkto nr. 0392400M)

3: Mousseur (Produkto nr. 13952000)

4: Shank mounting kit (Produkto nr. 45004000)