

19 808 001 **COSTA L CONCEALED VALVE EXPOSED PART**

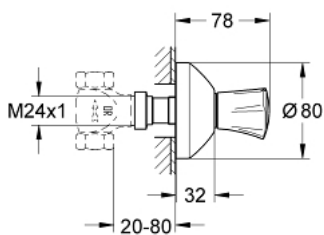

PRODUKTO APRAŠYMAS

- Spalva: chrome
- set for final installation for
- 35 028 000
- for GROHE concealed valves, 1/2", 3/4", 1"
- installation depth infinitely adjustable 20-80 mm
- escutcheon with wall sealing
- screwable
- metal handle
- heat-insulated
- marking: blue
- GROHE Long-Life finish



19 808 001 **COSTA L CONCEALED VALVE EXPOSED PART**

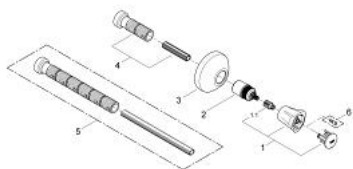

ATSARGINĖS DALYS , birželio 2007 – dabar

1: Handle (Produkto nr. 45994000)

1.1: Snap insert (Produkto nr. 0538600M)

2: Extension for spindle (Produkto nr. 45204000)

3: Escutcheon (Produkto nr. 45219000)

4: Extension-set, 80 mm (Produkto nr. 45202000)

5: Extension-set 200 mm (Produkto nr. 45203000)*

6: Screw for Costa/Avina products (Produkto nr. 48013000)*

* pasirenkami priedai